

Verpackt in Tray -tray packaging
 Verpackungseinheit 18 Stück -packaging unit 18

Einzelheit X (M 2:1)
 detail X (scale 2:1)

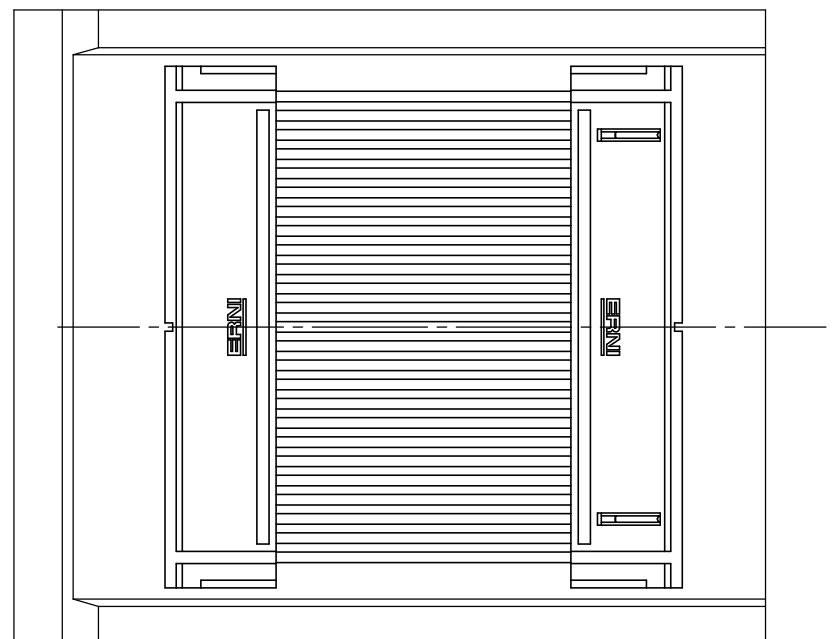
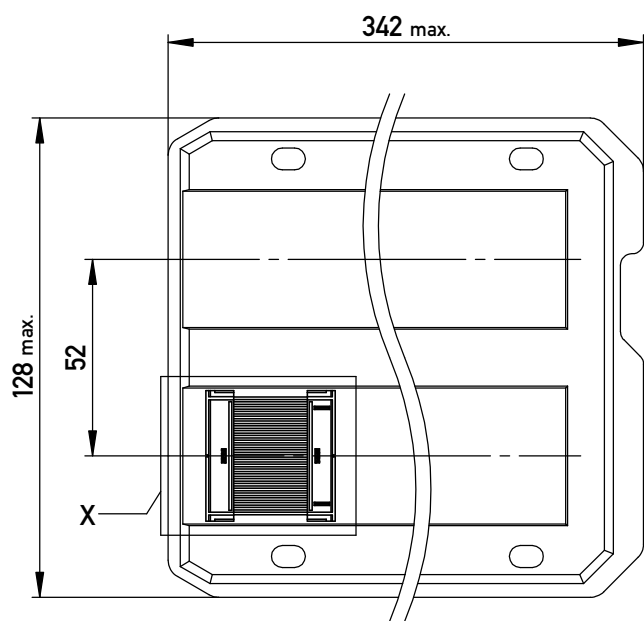

Adapterstück für board-to-board Abstand von 36mm (beidseitig verbaut mit Federleiste: 154807, Low Profile)
 Adapter for board-to-board height 36mm (in combination with two female connectors: 154807, low profile)

Information:		Tolerances	 All Dimensions in mm	Scale	3:1
All rights reserved. Only for Information. To ensure that this is the latest version of this drawing, please contact one of the ERNI companies before using.		Subject to modification without prior notice. Drawing will not be updated.		Designation	
Copyright by ERNI Production GmbH & Co. KG Proprietary notice pursuant to ISO 16016 to be observed.		www.ERNI.com		1,27 DRC BTB 36mm 50-polig 1,27 DRC BTB 36mm 50-pin	
b	12.08.2016			354315	
Index	Date			Class	DRCBTB
					I
					A3